



BRISA

**CORROSION-RESISTANT
AND ENERGY-EFFICIENT**

From residential streets to access roads: the BRISA makes it possible to illuminate the entire living environment with a single luminaire line. The BRISA features tilt adjustment to shine the light beam exactly where you need it under all circumstances. There is also a BRISA with a spherical diffuser, making it suitable for use as guidance lighting. The BRISA Optica is a further option for the BRISA family. The Optica features a spherical diffuser rather than a flat glass plate. The frosted coating on the optical lens generates a soft lighting effect and results in ultimate light comfort.



Application areas



Characteristics



PRODUCT SPECIFICATIONS

- Housing aluminum double coated (RAL 9007, 9005 and 7016)
- Light cover clear safety glass
- For pole size 60 mm/48 mm (pole- and bracket mounted)
- For pole size 76 mm (pole-mounted only)
- Tilt angle adjustable from 0 to 15° (pole mounting 60 mm), -15 to 0° (bracket mounting 48/60 mm), 0 to 10° (pole mounting 76 mm)
- Mass: ± 6 kg (depends on model)
- Wind surface: ± 0.01 m² (front), ± 0.03 m² (side)
- Safety class: I
- Assembly-, installation- and maintenance-friendly
- Voltage: 230/240 V, 50 Hz
- Standard Surge Protection (CM/DM) 10kV/6kV
- Standard cable type HO5BQ-F 3 x 1 mm²
- As standard in 8, 16, 24 or 32 LEDs
- Color temperature standard neutral white (4000K) or 3000K (warm white)
- CRI: > 70
- Expected lifespan 100.000 hours at T environment = 25°C (L96/F10)
- Different lens configurations
- LED2WELL-Core

OPTIONS

- Other RAL colour
- Safety class: II
- Several dimmable options available: Dali, Dynadimmer (integrated in driver), 1-10 V
- Constant Lumen Output (CLO)
- Other pre-fitted cable
- Protection to prevent light pollution
- Spherical diffuser or Optica
- LED2WELL-Pro

DIMENSIONS BRISA IN MM

Pole size 48/60 (bracket mounted)

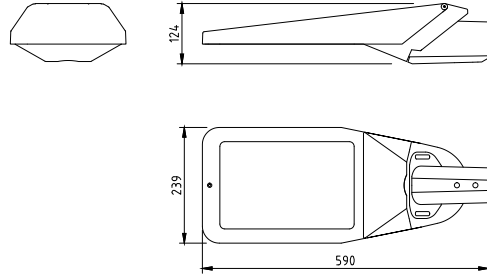

Pole size 48/60 (pole mounted)

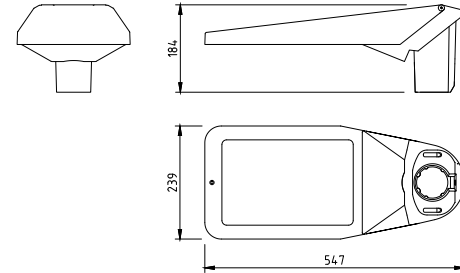

Pole size 76 (pole mounted)

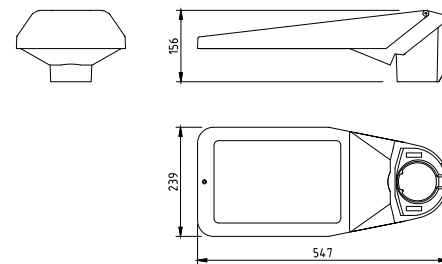

SMART CITY READY (optional)

Zhaga book 18 connector and screw cap (waterproof, IP66).



OPTICA

For diffused illumination and the ultimate in lighting comfort. Applicable for all BRISA models, with the exception of the BRISA EXL.

SPHERICAL DIFFUSER

For orientation lighting. Applicable for all BRISA models, with the exception of the BRISA EXL.



Lightronics supplies its luminaires as standard as Easy Light, with five standard dimming schedules (1A, 2A, 3A, 4A or 5A) that can switch capacity and brightness based on pre-set times.



Lightronics offers full system integration with Controlled Solutions. This includes the use of communication modules from brands such as CityTouch, Luminext, or TVilight.



As an option, this luminaire can be provided with a Zhaga book 18 connector and is Zhaga-D4i certified. This means that the luminaire can communicate with all sensors and nodes that also dispose of a Zhaga-D4i certificate and is as such suitable for the latest developments in the field of smart lighting and connectivity.



The smart lighting system SmartScan optimises the use of luminaires in your environment. Thanks to wireless communication, there is always sufficient light when required and energy is saved.

BRISA | LED²WELL CORE OUR STANDARD LIGHTING SOLUTION

Number of LEDs	Lumen	3000K		4000K	
		LED-power (W)	System power (W)	LED-power (W)	System power (W)
8	800	4,7	6,8	4,5	6,5
	1050	6,1	8,2	5,6	7,7
	1200	7,1	9,3	6,6	8,8
	1350	8,2	10,5	7,6	9,9
	1500	9,1	11,5	8,6	10,9
	1600	10,0	12,4	9,4	11,8
	1800	11,1	14,2	10,2	13,2
	2000	12,6	15,8	11,5	14,6
16	800	5,7	8,0	5,5	7,7
	1050	6,8	9,0	6,3	8,6
	1200	7,5	9,8	7,2	9,5
	1350	8,1	10,5	7,9	10,2
	1500	8,8	11,2	8,5	10,9
	1600	9,3	11,7	9,0	11,4
	1800	10,4	12,8	10,0	12,4
	2000	11,2	13,7	10,6	13,1
	2150	12,4	14,9	11,5	13,9
	2300	13,5	16,1	12,6	15,1
	2500	14,8	17,5	14,2	16,8
	2750	16,6	19,4	15,7	18,5
	3000	18,5	21,4	17,3	20,1
	3240	20,3	23,3	18,9	21,8
	3500	21,3	24,3	19,4	22,3
	3780	22,1	25,2	20,8	23,8
4000	24,5	27,7	22,6	25,7	
4200	25,6	29,0	24,5	27,7	
24	2500	12,8	15,7	12,1	15,1
	2750	14,1	17,1	13,5	16,4
	3000	16,9	20,1	15,9	19,1
	3240	18,5	21,9	17,2	20,5
	3500	20,5	24,1	19,2	22,6
	3780	22,6	26,2	21,2	24,7
	4000	23,6	27,2	23,0	26,6
	4200	25,7	29,4	23,6	27,2
	4320	25,9	29,7	24,7	28,3
	4860	30,5	34,5	28,4	32,3
	5000	27,7	31,3	26,0	29,6
	5200	28,7	32,4	27,0	30,6
	5670	31,7	35,6	29,7	33,5
	6000	33,8	37,8	31,7	35,6

BRISA | LED²WELL CORE OUR STANDARD LIGHTING SOLUTION

		3000K		4000K	
Number of LEDs	Lumen	LED-power (W)	System power (W)	LED-power (W)	System power (W)
32	3240	18,7	22,0	17,7	21,1
	3500	19,9	23,4	19,5	22,9
	3780	20,8	24,2	20,4	23,8
	4000	22,1	25,6	20,8	24,2
	4320	24,3	27,8	22,9	26,5
	4860	28,3	32,1	26,6	30,3
	5200	30,9	34,8	29,2	33,0
	5670	33,7	37,7	31,8	35,7
	6000	36,0	40,1	34,1	38,1
	6480	40,0	44,2	37,3	41,5
	6840	42,2	46,6	40,0	44,2
	7290	51,1	50,5	42,2	46,6
	7560	47,8	52,4	45,1	49,6
	7800	49,6	54,3	46,8	51,5
	8000	50,5	55,4	47,8	52,4

BRISA | LED²WELL PRO OUR ENERGY-EFFICIENT SOLUTION FOR ULTIMATE LIGHTING COMFORT

		3000K		4000K	
Number of LEDs	Lumen	LED-power (W)	System power (W)	LED-power (W)	System power (W)
16	800	4,2	6,7	3,8	6,4
	1050	5,5	8,2	5,2	7,7
	1200	6,4	9,1	5,9	8,6
	1350	7,3	10,1	6,8	9,6
	1500	8,1	11,0	7,6	10,5
	1600	8,7	11,7	8,2	11,1
	1800	9,9	12,9	9,3	12,3
	2000	11,1	14,4	10,4	13,6
32	800	3,6	5,8	3,3	5,5
	1050	5,0	7,3	4,8	7,0
	1200	5,7	8,0	5,5	7,7
	1350	6,5	8,9	6,3	8,6
	1500	7,4	9,8	7,0	9,3
	1600	8,1	10,4	7,6	10,0
	1800	8,9	11,3	8,5	10,9
	2000	10,0	12,4	9,6	12,0
	2150	10,7	13,1	10,2	12,7
	2300	11,3	13,8	11,1	13,6
	2500	12,8	15,4	12,2	14,7
	2750	14,1	16,7	13,5	16,1
	3000	15,2	17,9	14,8	17,5
	3240	18,5	21,5	17,2	20,1
	3500	20,1	23,2	18,9	22,0
	3780	21,9	25,1	20,5	23,7
4000	23,5	26,8	21,9	25,1	
4200	25,0	28,5	23,5	26,8	
48	2500	12,8	15,7	12,1	15,1
	2750	14,1	17,1	13,5	16,4
	3000	15,8	18,8	15,1	18,1
	3240	17,1	20,2	16,1	19,2
	3500	18,7	21,9	17,7	20,9
	3780	20,4	23,6	19,1	22,2
	4000	21,7	25,1	20,4	23,6
	4200	22,7	26,1	21,4	24,7
	4320	23,4	26,8	22,0	25,4
	4860	26,7	30,3	25,1	28,6
	5000	27,7	31,3	26,0	29,6
	5200	28,7	32,4	27,0	30,6
	5670	31,7	35,6	29,7	33,5
	6000	33,8	37,8	31,7	35,6

BRISA | LED²WELL PRO OUR ENERGY-EFFICIENT SOLUTION FOR ULTIMATE LIGHTING COMFORT

		3000K		4000K	
Number of LEDs	Lumen	LED-power (W)	System power (W)	LED-power (W)	System power (W)
64	3240	16,6	19,9	15,8	19,2
	3500	18,0	21,4	17,1	20,7
	3780	19,3	23,2	18,8	22,4
	4000	20,6	24,1	19,7	23,3
	4320	22,3	26,0	21,5	25,1
	4860	25,9	29,3	25,0	28,3
	5200	27,6	31,4	26,7	30,3
	5670	30,3	34,3	29,4	33,1
	6000	32,5	36,4	31,2	35,1
	6480	35,6	39,5	34,3	38,1
	6840	37,4	41,9	36,1	40,4
	7290	40,5	44,8	38,8	43,2
	7560	42,3	46,7	41,0	45,1
	7800	43,7	48,4	42,3	46,7
	8000	45,5	49,7	43,7	48,0



BRISA WALK

GREATER ROAD SAFETY

The BRISA family includes a number of specific variants, including the BRISA WALK. The BRISA WALK's optical system has been specifically designed for pedestrian crossings. The optical system creates a strong contrast with the surroundings to illuminate pedestrians more clearly. This contributes to greater traffic safety. Tilt adjustment ensures exactly the right light pattern for every situation. The BRISA WALK can be supplied with a spherical diffuser for guidance lighting.



Application areas



Characteristics



IP 66

IK 10



ENEC



OPTIONS



PRODUCT SPECIFICATIONS

- Housing aluminum double coated (RAL 9007, 9005 and 7016)
- Light cover clear safety glass
- For pole size 60 mm/48 mm (pole- and bracket mounted)
- For pole size 76 mm (pole-mounted only)
- Tilt angle adjustable from 0 to 15° (pole mounting 60 mm), -15 to 0° (bracket mounting 48/60 mm), 0 to 10° (pole mounting 76 mm)
- Mass: ± 6 kg (depends on model)
- Wind surface: ± 0.01 m² (front), ± 0.03 m² (side)
- Safety class: I
- Assembly-, installation- and maintenance-friendly
- Voltage: 230/240 V, 50 Hz
- Standard Surge Protection (CM/DM) 10kV/6kV
- Standard cable type HO5BQ-F 3 x 1 mm²
- As standard in 16 or 32 LEDs
- Color temperature standard neutral white (4000K) or 3000K (warm white)
- CRI: > 70
- Expected lifespan 100.000 hours at T environment = 25 C (L96/F10)
- Lightprofile: direct beam, mast height 5 – 6 meter
- LED2WELL-Core

OPTIONS

- Other RAL colour
- Safety class: II
- Several dimmable options available: Dali, Dynadimmer (integrated in driver), 1-10 V
- Constant Lumen Output (CLO)
- Other pre-fitted cable
- Protection to prevent light pollution
- Spherical diffuser or Optica
- LED2WELL-Pro

DIMENSIONS BRISA WALK IN MM

Pole size 48/60 (bracket mounted)

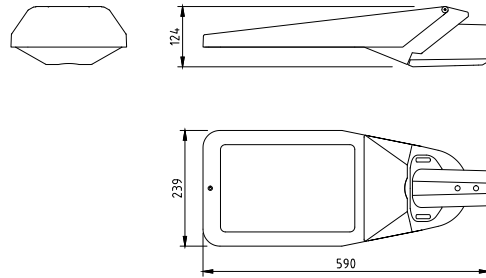

Pole size 48/60 (pole mounted)

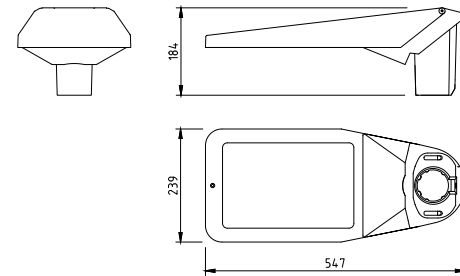

Pole size 76 (pole mounted)

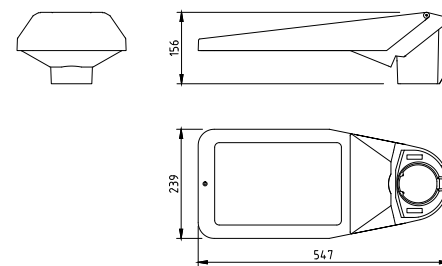

SMART CITY READY (optional)

Zhaga book 18 connector and screw cap (waterproof, IP66)



OPTICA

For diffused illumination and the ultimate in lighting comfort. Applicable for all BRISA models, with the exception of the BRISA EXL.



SPHERICAL DIFFUSER

For orientation lighting. Applicable for all BRISA models, with the exception of the BRISA EXL.



Lightronics supplies its luminaires as standard as Easy Light, with five standard dimming schedules (1A, 2A, 3A, 4A or 5A) that can switch capacity and brightness based on pre-set times.



Lightronics offers full system integration with Controlled Solutions. This includes the use of communication modules from brands such as CityTouch, Luminext, or TVilight.



As an option, this luminaire can be provided with a Zhaga book 18 connector and is Zhaga-D4i certified. This means that the luminaire can communicate with all sensors and nodes that also dispose of a Zhaga-D4i certificate and is as such suitable for the latest developments in the field of smart lighting and connectivity.



The smart lighting system SmartScan optimises the use of luminaires in your environment. Thanks to wireless communication, there is always sufficient light when required and energy is saved.

BRISA WALK | LED²WELL CORE OUR STANDARD LIGHTING SOLUTION

		3000K		4000K	
Number of LEDs	Lumen	LED-power (W)	System power (W)	LED-power (W)	System power (W)
16	800	5,7	8,0	5,5	7,7
	1050	6,8	9,0	6,3	8,6
	1200	7,5	9,8	7,2	9,5
	1350	8,1	10,5	7,9	10,2
	1500	8,8	11,2	8,5	10,9
	1600	9,3	11,7	9,0	11,4
	1800	10,4	12,8	10,0	12,4
	2000	11,2	13,7	10,6	13,1
	2150	12,4	14,9	11,5	13,9
	2300	13,5	16,1	12,6	15,1
	2500	14,8	17,5	14,2	16,8
	2750	16,6	19,4	15,7	18,5
	3000	18,5	21,4	17,3	20,1
	3240	20,3	23,3	18,9	21,8
	3500	21,3	24,3	19,4	22,3
	3780	22,1	25,2	20,8	23,8
4000	24,5	27,7	22,6	25,7	
4200	25,6	29,0	24,5	27,7	
32	3240	18,7	22,0	17,7	21,1
	3500	19,9	23,4	19,5	22,9
	3780	20,8	24,2	20,4	23,8
	4000	22,1	25,6	20,8	24,2
	4320	24,3	27,8	22,9	26,5
	4860	28,3	32,1	26,6	30,3
	5200	30,9	34,8	29,2	33,0
	5670	33,7	37,7	31,8	35,7
	6000	36,0	40,1	34,1	38,1
	6480	40,0	44,2	37,3	41,5
	6840	42,2	46,6	40,0	44,2
	7290	51,1	50,5	42,2	46,6
	7560	47,8	52,4	45,1	49,6
	7800	49,6	54,3	46,8	51,5
8000	50,5	55,4	47,8	52,4	



BRISA BIKE

— GREATER ROAD SAFETY

The BRISA BIKE luminaire features an adapted lens for narrow light profiles. As a result, the spacing between the posts can be increased to 30 metres at a post height of four metres. The lenses used for the BRISA BIKE make it the perfect luminaire for cycle paths, back alleys, footpaths or narrow roads. The BRISA BIKE has tilt adjustment to ensure exactly the right light throw for every situation. The BRISA BIKE can also be supplied with a spherical diffuser for guidance lighting.



Application areas



Characteristics



OPTIONS



PRODUCT SPECIFICATIONS

- Housing aluminum double coated (RAL 9007, 9005 and 7016)
- Light cover clear safety glass
- For pole size 60 mm/48 mm (pole- and bracket mounted)
- For pole size 76 mm (pole-mounted only)
- Tilt angle adjustable from 0 to 15° (pole mounting 60 mm), -15 to 0° (bracket mounting 48/60 mm), 0 to 10° (pole mounting 76 mm)
- Mass: ± 6 kg (depends on model)
- Wind surface: ± 0.01 m² (front), ± 0.03 m² (side)
- Safety class: I
- Assembly-, installation- and maintenance-friendly
- Voltage: 230/240 V, 50 Hz
- Standard Surge Protection (CM/DM) 10kV/6kV
- Standard cable type HO5BQ-F 3 x 1 mm²
- As standard in 8 or 16 LEDs
- Color temperature standard neutral white (4000K) or 3000K (warm white)
- CRI: > 70
- Expected lifespan 100.000 hours at T environment = 25 C (L96/F10)
- Lightprofile: wide distribution, mast height 4, 5, 6 meters
- LED2WELL-Core

OPTIONS

- Other RAL colour
- Safety class: II
- Several dimmable options available: Dali, Dynadimmer (integrated in driver), 1-10 V
- Constant Lumen Output (CLO)
- Other pre-fitted cable
- Protection to prevent light pollution
- Spherical diffuser or Optica
- LED2WELL-Pro



OPTICA

For diffused illumination and the ultimate in lighting comfort. Applicable for all BRISA models, with the exception of the BRISA EXL.



SPHERICAL DIFFUSER

For orientation lighting. Applicable for all BRISA models, with the exception of the BRISA EXL.

DIMENSIONS BRISA BIKE IN MM

Pole size 48/60 (bracket mounted)

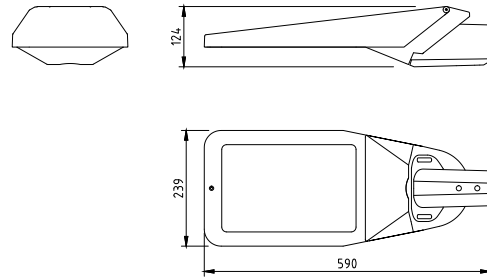

Pole size 48/60 (pole mounted)

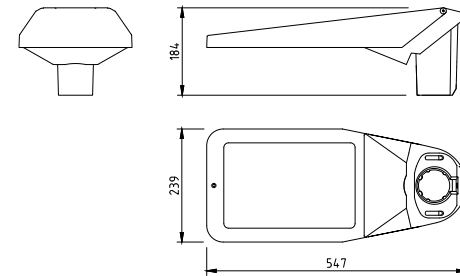

Pole size 76 (pole mounted)

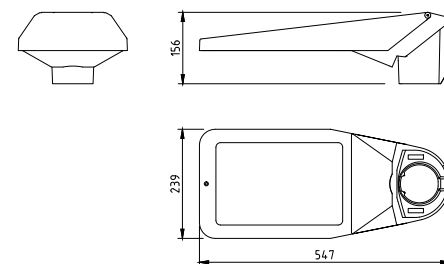

SMART CITY READY (optional)

Zhaga book 18 connector and screw cap (waterproof, IP66)





Lightronics supplies its luminaires as standard as Easy Light, with five standard dimming schedules (1A, 2A, 3A, 4A or 5A) that can switch capacity and brightness based on pre-set times.



Lightronics offers full system integration with Controlled Solutions. This includes the use of communication modules from brands such as CityTouch, Luminext or TVilight.



As an option, this luminaire can be provided with a Zhaga book 18 connector and is Zhaga-D4i certified. This means that the luminaire can communicate with all sensors and nodes that also dispose of a Zhaga-D4i certificate and is as such suitable for the latest developments in the field of smart lighting and connectivity.



The smart lighting system SmartScan optimises the use of luminaires in your environment. Thanks to wireless communication, there is always sufficient light when required and energy is saved.

BRISA BIKE LED ² WELL CORE OUR STANDARD LIGHTING SOLUTION					
		3000K		4000K	
Number of LEDs	Lumen	LED-power (W)	System power (W)	LED-power (W)	System power (W)
8	800	4,7	6,8	4,5	6,5
	1050	6,1	8,2	5,6	7,7
	1200	7,1	9,3	6,6	8,8
	1350	8,2	10,5	7,6	9,9
	1500	9,1	11,5	8,6	10,9
	1600	10,0	12,4	9,4	11,8
	1800	11,1	14,2	10,2	13,2
	2000	12,6	15,8	11,5	14,6
16	800	5,7	8,0	5,5	7,7
	1050	6,8	9,0	6,3	8,6
	1200	7,5	9,8	7,2	9,5
	1350	8,1	10,5	7,9	10,2
	1500	8,8	11,2	8,5	10,9
	1600	9,3	11,7	9,0	11,4
	1800	10,4	12,8	10,0	12,4
	2000	11,2	13,7	10,6	13,1
	2150	12,4	14,9	11,5	13,9
	2300	13,5	16,1	12,6	15,1
	2500	14,8	17,5	14,2	16,8
	2750	16,6	19,4	15,7	18,5
	3000	18,5	21,4	17,3	20,1
	3240	20,3	23,3	18,9	21,8
	3500	21,3	24,3	19,4	22,3
	3780	22,1	25,2	20,8	23,8
4000	24,5	27,7	22,6	25,7	
4200	25,6	29,0	24,5	27,7	



BRISA BAT (AMBER)

RESPECT FOR THE LIVING ENVIRONMENT

Bats are protected animals in the Netherlands. All bat species are strictly protected under the Nature Protection Act. Lighting can affect bats' flight and migration routes and have an adverse effect on the foraging area they require to survive. With the BRISA BAT, Lightronics offers a solution that is ideal for most bat species. The BRISA BAT has an amber LED light source. Tilt adjustment ensures exactly the right light pattern for every situation. The BRISA BAT can also be supplied with a spherical diffuser for guidance lighting.



Application areas



ECOLOGICAL ZONES



BICYCLE PATHS



HOLIDAY PARKS



TRAILS

Characteristics



IP 66

IK 10



ENEC



OPTIONS



PRODUCT SPECIFICATIONS

- Housing aluminum double coated (RAL 9007, 9005 and 7016)
- Light cover clear safety glass
- For pole size 60 mm/48 mm (pole- and bracket mounted)
- For pole size 76 mm (pole-mounted only)
- Tilt angle adjustable from 0 to 15° (pole mounting 60 mm), -15 to 0° (bracket mounting 48/60 mm), 0 to 10° (pole mounting 76 mm)
- Mass: ± 6 kg (depends on model)
- Wind surface: ± 0.01 m² (front), ± 0.03 m² (side)
- Safety class: I
- Assembly-, installation- and maintenance-friendly
- Voltage: 230/240 V, 50 Hz
- Standard Surge Protection (CM/DM) 10kV/6kV
- Standard cable type HO5BQ-F 3 x 1 mm²
- As standard in 16 or 32 LEDs
- LED: Amber, wavelength 591 nm
- CRI: > 70
- Expected lifespan 100.000 hours at T environment = 25°C (L96/F10)
- Different lens configurations
- LED2WELL-Core

OPTIONS

- Other RAL colour
- Safety class: II
- Several dimmable options available: Dali, Dyna-dimmer (integrated in driver), 1-10 V
- Constant Lumen Output (CLO)
- Other pre-fitted cable
- Protection to prevent light pollution
- Spherical diffuser or Optica
- LED2WELL-Pro

DIMENSIONS BRISA BAT IN MM

Pole size 48/60 (bracket mounted)

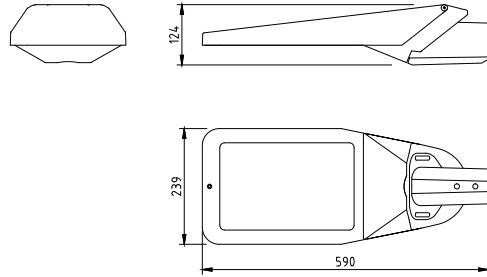

Pole size 48/60 (pole mounted)

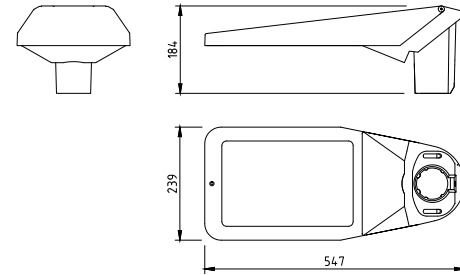

Pole size 76 (pole mounted)

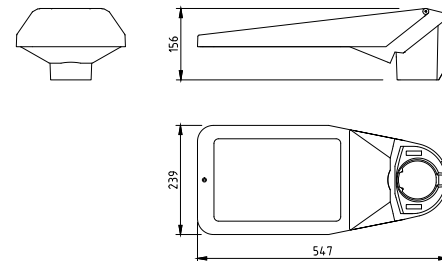

SMART CITY READY (optioneel)

Zhaga book 18 connector and screw cap (waterproof, IP66)



 **OPTICA**

For diffused illumination and the ultimate in lighting comfort. Applicable for all BRISA models, with the exception of the BRISA EXL.

 **SPHERICAL DIFFUSER**

For orientation lighting. Applicable for all BRISA models, with the exception of the BRISA EXL.



Lightronics supplies its luminaires as standard as Easy Light, with five standard dimming schedules (1A, 2A, 3A, 4A or 5A) that can switch capacity and brightness based on pre-set times.



Lightronics offers full system integration with Controlled Solutions. This includes the use of communication modules from brands such as CityTouch, Luminext or TVilight.



As an option, this luminaire can be provided with a Zhaga book 18 connector and is Zhaga-D4i certified. This means that the luminaire can communicate with all sensors and nodes that also dispose of a Zhaga-D4i certificate and is as such suitable for the latest developments in the field of smart lighting and connectivity.



The smart lighting system SmartScan optimises the use of luminaires in your environment. Thanks to wireless communication, there is always sufficient light when required and energy is saved.

BRISA BAT			
Number of LEDs	Lumen	AMBER LED	
		LED-power (W)	System power (W)
16	800	13,0	14,0
	1200	18,6	20,0
	1600	27,0	29,0
32	2000	34,4	37,0
	2350	38,1	41,0
	2500	41,9	45,0
	3000	51,2	55,0