



PRUNUS E

— FLEXIBLE SLIDE-ON AND TOP-MOUNTED LUMINAIRE

With the PRUNUS E, you can choose between a top-mounted and a slide-on luminaire. The flexible tilt angle allows you to position the luminaire to shine light where you need it. The PRUNUS E is available in 4 different light covers and optional LED ring to give any environment an accent of its own. As a member of the modular PRUNUS family, it is possible to assign the entire living environment its own identity, while styling it attractively.

Application areas

- 
 RESIDENTIAL AREAS
- 
 SQUARES AND PARKS
- 
 BUSINESS PARKS
- 
 CITY AND VILLAGE CENTERS
- 
 DISTRICT ACCESS ROADS
- 
 SEPARATE CYCLE PATHS
- 
 PARKING LOTS



Characteristics

- EASY LIGHT
- IP 66
- IK 10
- CE

OPTIONS

- CONTROLLED SOLUTIONS
- ZD⁴
- ☁️

PRODUCT SPECIFICATIONS

- Aluminium top cover coated
- Standard colour: RAL 7016
- Flat light cover (E1 / E2) polycarbonate, clear
- Lens-shaped light cover (E3 / E4): structured polycarbonate, clear (E3), safety glass, clear (E4)
- Pole-mount size: 60 mm
- Bracket-mount size: 60/48 mm
- Tilt angle adjustable
Pole-mounted: 0° to 20° (in 5°)
Bracket-mounted: -20° to + 20° (in 5°)
- Mass: ± 5 kg (depends on model)
- Front wind surface: 0.05 m² (E1 / E2), 0.07 m² (E3), 0.06 m² (E4)
- Side wind surface: 0.06 m² (E1 / E2), 0.08 m² (E3), 0.07 m² (E4)
- Safety class: I
- Assembly-, installation- and maintenance-friendly
- Voltage: 230/240 V, 50 Hz
- Standard Surge Protection (CM/DM): 8 kV/6 kV
- Standard cable type H05BQ-F (3x1.0 mm²)
- CRI: > 70
- Colour temperature neutral white (4000K) or warm white (3000K)
- Expected lifespan 100.000 hours at T environment = 25°C (L96/F10)
- Various light distributions
- LED2WELL-Core

RGB LED-RING (optional)

RGB LED ring top cover silicone (semi-transparent)

- | | |
|--|--|
|  Lavender White |  Eco Green |
|  Sun Yellow |  Ocean Blue |
|  Scarlet Red |  Evening Red |
|  Sky Blue |  Royal Orange |

Colours may differ from brochure printed colours.

OPTIONS

- Other RAL colour
- Safety class II
- Several dimming options: Dali, Dynadimmer (integrated in driver), 1-10 V
- Constant Lumen Output (CLO)
- Other pre-fitted cable
- LED2WELL-Pro

DIMENSIONS PRUNUS E IN MM

PRUNUS E1

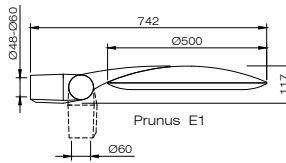

PRUNUS E2

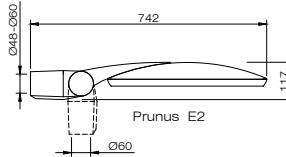

PRUNUS E3

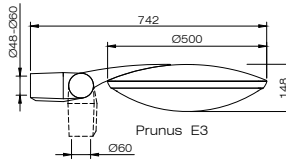

PRUNUS E4

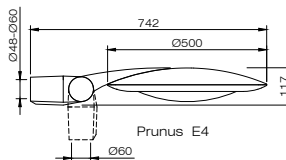

SMART CITY READY (optional)

Zhaga book 18 connector and screw cap (waterproof, IP66)



PRUNUS E | LED WELL CORE OUR STANDARD LIGHTING SOLUTION

Number of LEDs	Lumen	3000K		4000K	
		LED-power(W)	System power(W)	LED-power(W)	System power(W)
16	800	5,7	8,0	5,5	7,7
	1050	6,8	9,0	6,3	8,6
	1200	7,5	9,8	7,2	9,5
	1350	8,1	10,5	7,9	10,2
	1500	8,8	11,2	8,5	10,9
	1600	9,3	11,7	9,0	11,4
	1800	10,4	12,8	10,0	12,4
	2000	11,2	13,7	10,6	13,1
	2150	12,4	14,9	11,5	13,9
	2300	13,5	16,1	12,6	15,1
	2500	14,8	17,5	14,2	16,8
	2750	16,6	19,4	15,7	18,5
	3000	18,5	21,4	17,3	20,1
	3240	20,3	23,3	18,9	21,8
	3500	22,1	25,2	20,8	23,8
	3780	24,5	27,7	22,6	25,7
4000	25,6	29,0	24,5	27,7	
4200	27,5	31,0	25,6	29,0	
32	4320	24,3	27,8	22,9	26,5
	4860	28,3	32,1	26,6	30,3
	5200	30,9	34,8	29,2	33,0
	5670	33,7	37,7	31,8	35,7
	6000	36	40,1	34,1	38,1



Lightronics supplies its luminaires as standard as Easy Light, with five standard dimming schedules (1A, 2A, 3A, 4A or 5A) that can switch capacity and brightness based on pre-set times.



Lightronics offers full system integration with Controlled Solutions. This includes the use of communication modules from brands such as CityTouch, Luminext or TVilight.



As an option, this luminaire can be provided with a Zhaga book 18 connector and is Zhaga-D4i certified. This means that the luminaire can communicate with all sensors and nodes that also dispose of a Zhaga-D4i certificate and is as such suitable for the latest developments in the field of smart lighting and connectivity.



The smart lighting system SmartScan optimises the use of luminaires in your environment. Thanks to wireless communication, there is always sufficient light when required and energy is saved.

PRUNUS E | LED²WELL PRO OUR ENERGY-EFFICIENT SOLUTION FOR ULTIMATE LIGHTING COMFORT

Number of LEDs	Lumen	3000K		4000K	
		LED-power(W)	System power(W)	LED-power(W)	System power(W)
32	800	3,6	5,8	3,3	5,5
	1050	5,0	7,3	4,8	7,0
	1200	5,7	8,0	5,5	7,7
	1350	6,5	8,9	6,3	8,6
	1500	7,4	9,8	7,0	9,3
	1600	8,1	10,4	7,6	10,0
	1800	8,9	11,3	8,5	10,9
	2000	10,0	12,4	9,6	12,0
	2150	10,7	13,1	10,2	12,7
	2300	11,3	13,8	11,1	13,6
	2500	12,8	15,4	12,2	14,7
	2750	14,1	16,7	13,5	16,1
	3000	15,2	17,9	14,8	17,5
	3240	18,5	21,5	17,2	20,1
	3500	20,1	23,2	18,9	22,0
	3780	21,9	25,1	20,5	23,7
	4000	23,5	26,8	21,9	25,1
4200	25,0	28,5	23,5	26,8	
64	4320	22,3	26,0	21,4	25,1
	4860	25,8	29,3	25	28,3
	5200	27,6	31,4	26,7	30,3
	5670	30,3	34,3	29,4	33,1
	6000	32,5	36,4	31,2	35,1